

62 Ash Tree Road, Andover, SP10 3BY  
Guide Price £325,000



62 Ash Tree Road, Andover,  
Guide Price £325,000

PROPERTY DESCRIPTION BY Miss Molly Scruton

Graham and Co are delighted to present this two bedroom semi detached bungalow to market which has been upgraded by the current owner. The property comprises an entrance hall, two bedrooms, lounge and a kitchen with a rear porch. Outside there is driveway parking and a landscaped rear garden with a summer house.





Andover offers a good range of shopping and recreational facilities including a theatre, cinema, new leisure centre, excellent selection of schools and a college for higher education. An abundance of open space and land with a selection of local nature reserve's all within walking distance of the town centre. The town itself boast a lovely "market town" feel and everything you may need is close at hand. The mainline train station offers a fast service to London Waterloo in just over an hour, and the A303 gives access to London via the M3 and the West Country.



## Ash Tree Road, SP10

Approximate Gross Internal Area = 57.8 sq m / 622 sq ft  
 Outbuilding = 7.1 sq m / 76 sq ft  
 Total = 64.9 sq m / 698 sq ft

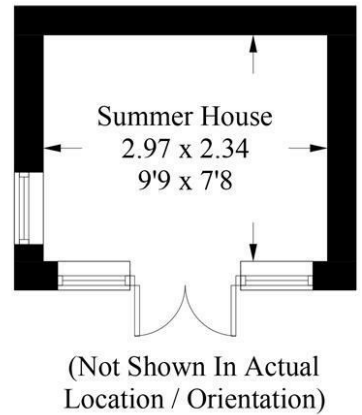
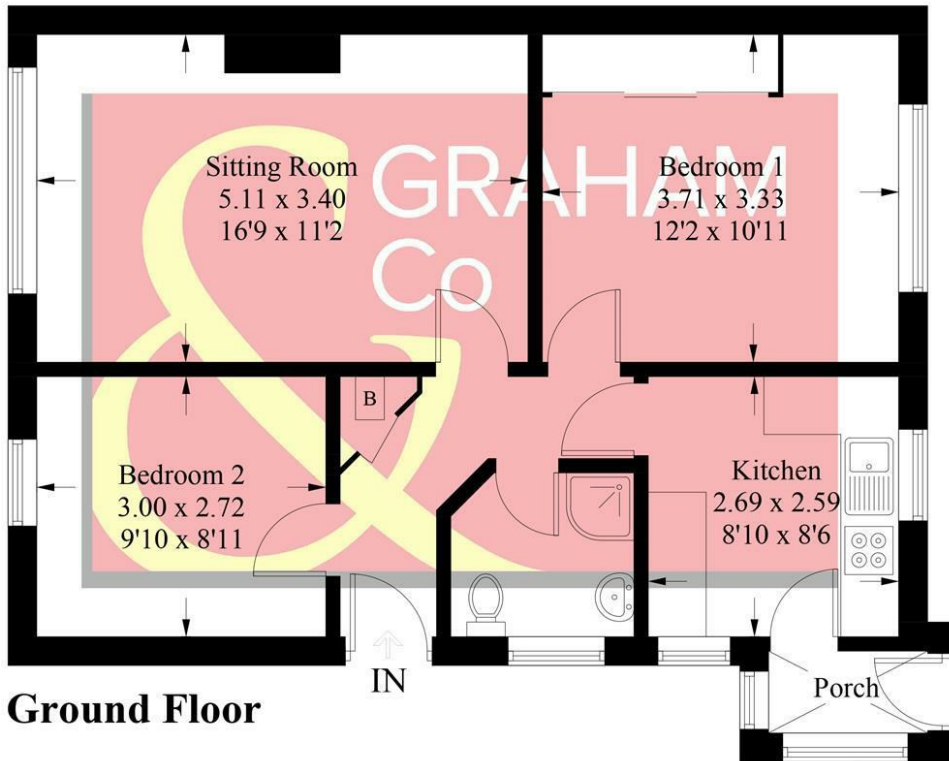

**Ground Floor**

PRODUCED FOR GRAHAM AND CO

Whilst every attempt has been made to ensure the accuracy of the floorplan, measurements of doors, windows and rooms are approximate. These plans are for representation purposes only as defined by RICS Code of Measuring Practice and used as such by any prospective purchaser. © Emzo Marketing (ID1024079)

### MORTGAGE ADVICE Across The Market Mortgages

An independent Mortgage brokerage offering expert advice from across the whole market. Whether you are a first-time buyer, home mover, remortgaging or buying a Buy-To-Let investment. Tristan can provide expert & reliable advice, in a clear jargon free language. Book a free consultation today.

E - [tristan@atmmortgages.com](mailto:tristan@atmmortgages.com) M - 07545320380

[www.atmmortgages.com](http://www.atmmortgages.com)

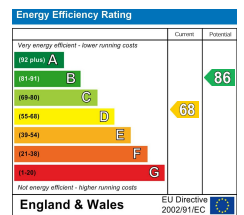

Tax Band: C



OPEN 7 DAYS

If you are considering selling your home please contact us today for your free no obligation valuation

**01264 356500**

IMPORTANT: we would like to inform prospective purchasers that these sales particulars have been prepared as a general guide only. A detailed survey has not been carried out, nor the services, appliances and fittings tested. Room sizes should not be relied upon for furnishing purposes and are approximate. If floor plans are included, they are for guidance only and illustration purposes only and may not be to scale. If there are any important matters likely to affect your decision to buy, please contact us before viewing the property.